

LUTHER F. CARSON FOUR RIVERS CENTER

CONTENTS

CONTACT INFORMATION
DRIVING DIRECTIONS
MAPS
TECHNICAL INFORMATION
AUDIO SYSTEM DESCRIPTION
LINESET SCHEDULE
CARSON CENTER IMAGES
MISCELLANEOUS

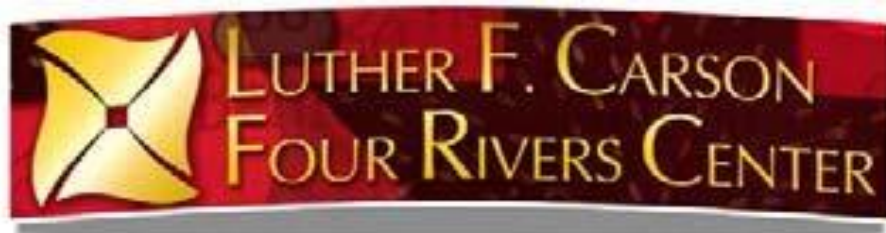

CONTACT INFORMATION

Mailing Address: Carson Center, 100 Kentucky Avenue, Paducah, KY. 42003-1500

Street Address: Carson Center, 100 Kentucky Avenue, Paducah, KY. 42003-1500

Web Page: <http://www.thecarsoncenter.org>

Contact Information:

Administration

TEL - (270) 443-9932

FAX - (270) 443-9947

Box office

TEL – (270) 450-4444

FAX – (270) 450-4000

Production Manager

Joe Searcy

TEL - (270) 443-9932 ext. 264

Email - jsearcy@thecarsoncenter.org

Location and Directions

Arrival Times should be coordinated with the house. Please inform us of your loading and parking needs.

From Nashville or Louisville

- * I-24 West to Paducah
- * Exit # 11 John Puryear Drive [becomes 3rd St.]
- * Turn right on Clark Street
- * Turn left on 2nd St. [This will put you at our loading dock]

From St. Louis or Chicago

- * I-24 East to Paducah
- * Exit # 4 US 60 [becomes 4th St.]
- * Turn left on Kentucky Ave.
- * Turn right on 1st St. [At the flood wall]
- * The dock will be at the back corner of the Center

Exit and Local Maps

EXIT 4

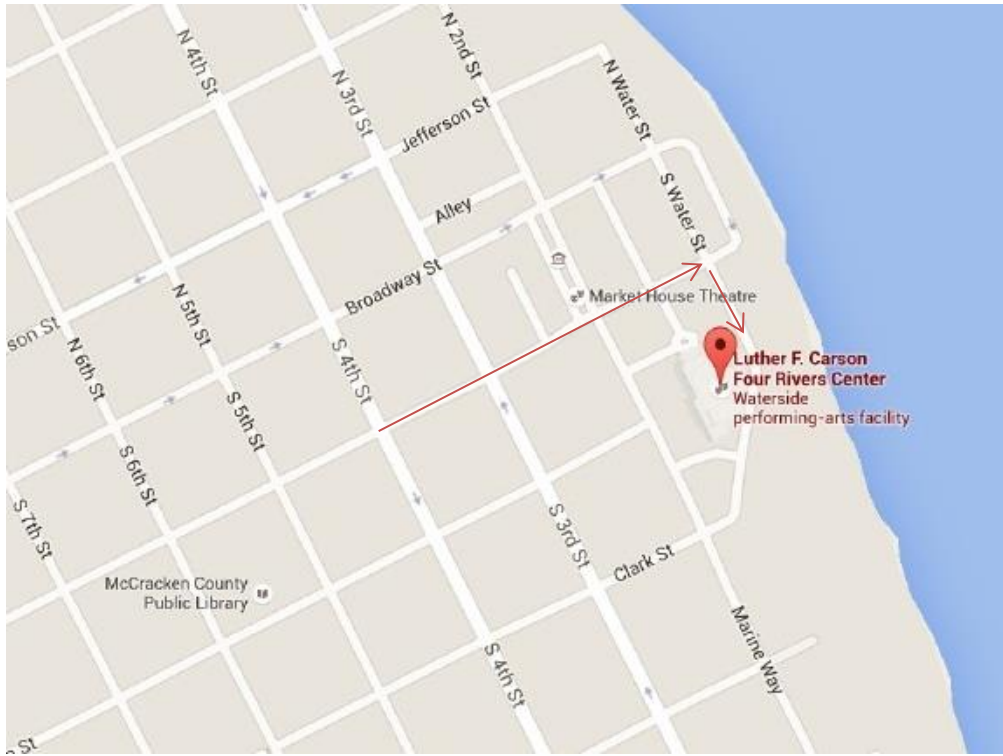
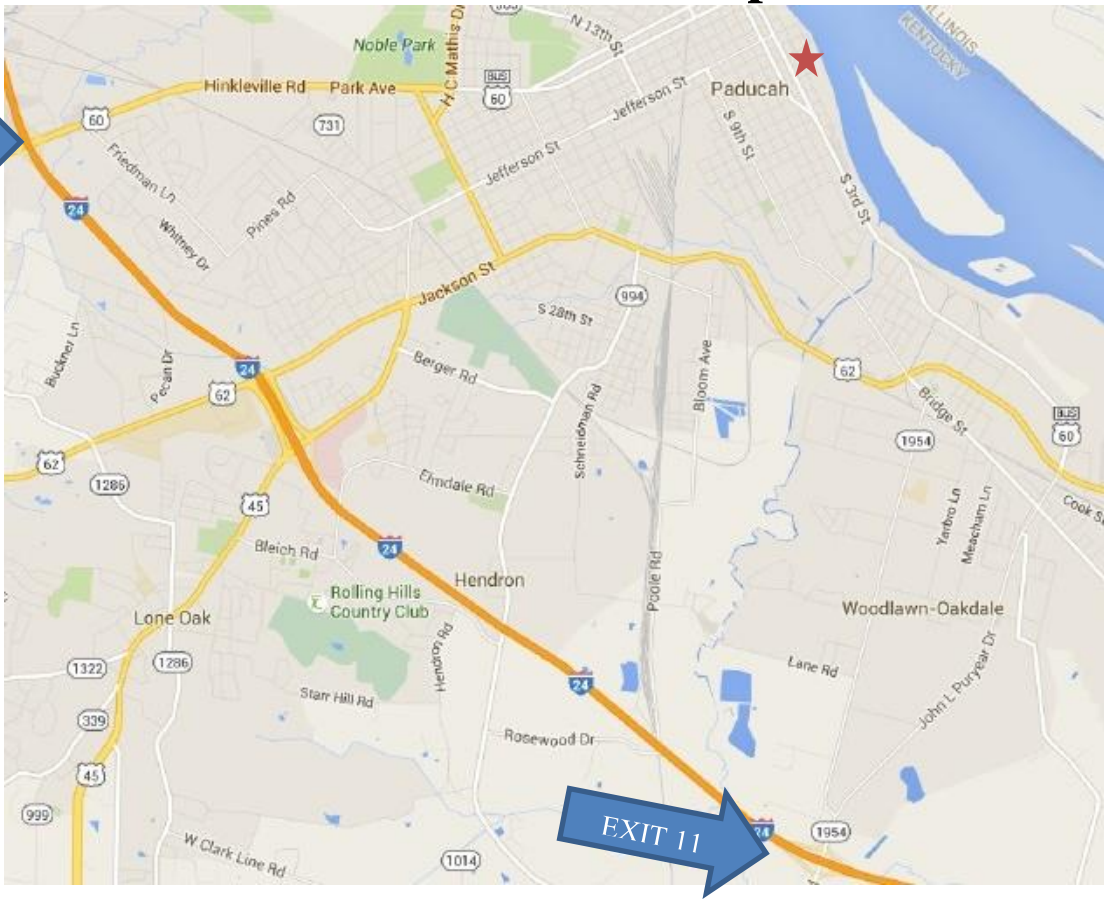

Carson Center
100 Kentucky Ave. Paducah, Kentucky
42003-1500
Joe Searcy (270) 443-9932 ext. 264
jsearcy@thecarsoncenter.org

APRIL, 2019

TECHNICAL INFORMATION

LOADING IN

- 2 Loading docks w/ dock levelers
- Doors 8' x 10'
- 1 Street level loading door; 8' x 12'
- All doors are roll up doors
- Dressing rooms, Laundry/Wardrobe are @ stage level

STAGE DIMENSIONS

- Proscenium width adjustable from 36'to 59'
- Proscenium height adjustable. [Speaker bridge is in Proscenium] [24' PLAY height]
- Rear plaster to back wall 44'9"
- Rear plaster to front of stage 3'
- Center line to fly rail stage left 50'6"
- Center line to stage right wall 46'6"
- Grid height 93'4"
- Stage height 3'6"
- Lift one drops to -9'
- Lift two drops to -11'
- 1st row of seats to edge of pit (downstage) 4'3"
- Edge of pit to stage lip 12'4"
- Edge of chair wagon lift to plaster 20'
- Stage floor to auditorium floor 3'6"
- Curtain line to edge of 1st balcony @ center 80'
- Curtain line to back wall of auditorium 100' @ orchestra level
- Cable Runs
 - S.R. to mix pit - 175'
 - S.R. to Control Room - 250'
 - S.R. to Dimmer Rack - 100'
 - S.R. to Projection Booth - 275'
 - S.L. to mix pit - 130'
 - S.L. to Control Room - 200'
 - S.L. to Spot Booth - 275'
 - S.L. to Projection - 225'
 - S.L. to S.R - 125'

RAIL

- 64 Single purchase; 7 lift line counterweight system @ stage left
- operating gallery @ +37'4"
- loading gallery @ +77'4"
- Trussed pipe battens 70' w/ 3' extension
- Batten trims in @ 4' above stage floor
- Batten travel is 86'

GOODS

- House curtain: Burgundy, manual draw, guillotine, 100% fullness @ 1' OC
- 6 Black velour Borders: 65'x15', flat
- 12 Black velour legs: 10'x45', flat
- 1 Black full stage bi-parting velour traveler: 65'x45', flat
- 1 Full stage blackout drop: 65'x45', flat
- 1 White cyclorama: 65'x45', flat

LIGHTING SYSTEM

- ETC Element 60/500 console
- 324 Strand CD-80SV production dimmers @ 2.4 kW. Circuits are distributed among 6 Front of House Positions & at Plug-in Gallery on Stage Right w/ Socapex multi cable providing cable runs to batten. 24 circuits available on deck, 6 at each corner of the stage.
- House lights may be controlled through consoles or at control panels located @ control room or backstage right.
- Onstage lx on line sets 12, 27, 42, 57 and 66

FRONT OF HOUSE LIGHTING POSITIONS

| POSITION | PURPOSE | FT TO PLASTER | HEIGHT | THROW ANGLE | DIMMER NUMBERS |
|------------------|-----------------|---------------|--------|-------------|----------------|
| RING CATWALK | PRIMARY FOH | 55'-75' | 59' | 38° | 115-138 |
| 2ND BALCONY | SECONDARY FOH | 88' | 34' | 23° | 85-108 |
| BOX BOOMS | DS SIDELIGHT | 3'-25' | 8'-38' | VARIOUS | 13-54 |
| 1ST BALCONY | DIRECT / LOW | 73' | 14' | 12° | 79-84 |
| EYEBROW CATWALK | DS TOPLIGHT | 27' | 50' | 62° | 139-162 |
| FOLLOWSPOT BOOMS | CURTAIN WARMERS | 105' | 55' | | |

INVENTORY

FOH – FOLLOWSPOT BOOTH

- 2 - Strong 2K Xenon Super Trooper
- 2 – Strong 2K Xenon Super Trooper II

FOH – EYEBROW

- 4 - 15° to 30° Source 4 Zooms
- 4 - 10° Source 4
- 1 - 5° Source 4

FOH – RING CATWALK

- 24 - 10° Source 4
- 8 - 5° Source 4

FOH – 2ND BALCONY

- 16 - 10° Source 4
- 8 - 15° to 30° Source 4 Zooms

FOH – 1ST BALCONY

- 2 - 15° to 30° Source 4 Zooms
- 4 - 10° Source 4

FOH – NEAR BOX BOOM

- 30 - 15° to 30° Source 4 Zooms
- 12 – 1K pars (crowd lights)

STAGE / STORAGE

- 52 - 15° to 30° Source 4 Zooms [7.5” frames]
- 100 - Altman Par 64
- 4 – ACL bars

MISCELLANEOUS ITEMS

Lightwave Research F-100 Fogger, 28 Gobo Holders [B], 11 Barndoors, NO Donuts, 40’ AC Powered Genie Personnel Lift, 19’ DC Powered Genie Scissor Lift

COMPANY SWITCHES – [all camlocks are female] and/or [bare wire]

120/208v. 400amp 3 phase 4 wire + ground

- 2 located @ mid stage right

120/208v. 200amp 3 phase 4 wire+ ground

- 1 located @ loading dock (with additional isolated ground)
- 1 located @ River Room in Southeast corner

120/208v. 100amp 3 phase 4 wire+ ground

- 1 located @ backstage right
- 1 located @ downstage left (isolated ground)
- 1 located @ grid level
- 1 located stage right @ proscenium header
- 1 located in follow spot booth 3rd tier
- 1 located in projection booth 2nd tier
- 1 located in River Room in Southwest corner
- 1 located in Tech. tunnel under control booth

AUDIO

SOUND MIX PIT

- Dedicated FOH area 76' from Stage (15' 6" x 9') with access to Tech Tunnel running from Main Booth to orchestra pit. (this is the cable path to FOH)
- 1 Midas M32 console
- CD/DVD player

SOUND CONTROL ROOM

- Patching & Tie Lines to all areas in theatre & backstage. (Main Patching Area)
- 1 Soundcraft Series Four 40 + 4 Tour Pack
- 1 DBX 2231 stereo 1/3 octave EQ
- 2 DBX 1231 stereo 1/3 octave EQ
- 1 DBX 1066 Comp/Expander/Gate/Limiter
- 2 DBX 1046 quad channel compressor
- 2 DBX 1074 quad channel gates
- 2 TC Electronics M-One Digital Processors
- 2 TC Electronics D-Two Delays
- 1 TC Electronics M-3000 Reverb Processor
- 1 Denon -T625 CD/Cassette deck

LOUDSPEAKER SYSTEM

- Sound System installed by Clair Brothers
- FOH sound is stereo full range capable of producing and sustaining 110 dB
- FOH Speakers are located in three positions (left, right and center) in a SPEAKER BRIDGE running the width of the proscenium opening that includes:
 - 8 - R2D-90h Loudspeaker - CBA
 - 4 - CS18 Sub-Woofer - CBA

IN ADDITION TO:

- 8 - P100IB Loudspeaker - PAS (front fills mounted along edge of stage)
- 24 - CMS-50-30 Under-Balcony Ceiling Loudspeaker - Tannoy
- 2 - R2D-60h Loudspeaker - CBA (mounted in grid of second balcony)

STACKS

- 4 EAW KF-850 3 way horn loaded speaker system
- 4 TMG FL-218 Front loaded 2x18" JBL 2441 subwoofers
- 1 DBX 480 system processor

MONITORS

- 6 - SM260IV Monitor Wedge loudspeaker - EAW
- 2 - JF260 Side Fill loudspeakers - EAW
- 2 - JF290 Side Fill loudspeakers - EAW

MICROPHONES

- 2 - Shure Beta 58A Vocal Microphone
- 2 - Shure Beta 52A Instrument Microphone
- 12 - Shure SM58 Handheld Microphone
- 4 - Sennheiser MD-421II Instrument Microphone
- 4 - Sennheiser E604 Instrument Microphone
- 8 - Shure SM57 Instrument Microphone
- 2 - AKG C-414B-ULS Recording/Reinforcement Microphone
- 2 - Shure SM81 Reinforcement Microphone
- 2 - Sennheiser MKH60-P48 Shotgun Reinforcement/Recording Microphone
- 5 - Crown PCC-160 Floor Microphone
- 4 - Shure U4D Wireless Microphone Receiver
- 2 - Shure U2/Beta58 Handheld transmitter
- 8 - Shure U1 Bodypack transmitter
- 1 - AKG Condenser Mic, Gooseneck podium
- 6 - Audix ADX51 condenser microphones
- 2 - Countrymen E6ILT earworm lavalier microphone

Portable Mixing Setup

- 1 – Midas Small Format Console
- 1 – QSC Power Amplifier
- 1 - Denon CD / Cassette Combo
- 2 - Ultimate Loudspeaker Stands

HEARING IMPAIRED SYSTEM

24 Sennheiser Stethoscope Receivers

COMMUNICATIONS

- 1 - Clear-com Master Station with four channel capability all in excellent working order
- 25 – Two-gang wall plates w/channel indicators
- 20 – Clear-com Single Channel Belt pack
- 5 – Clear-com Dual Channel Belt pack
- 20 – Beyer Headset single muff
- 5 – Clear-com Lightweight headset
- 2 – Clear-com Intercom handset

DRESSING ROOMS

- All Dressing Rooms have full Lavatories & Showers

Backstage measurements

- Green Room: 16 x 21
- Laundry Room: 8 x 32, w/ 2 washers, 2 dryers, 1 portable steamer, 2 irons & boards
- #1: 10 x 14 w/ 1 station
- #2: 10 x 14 w/ 1 station
- #3: 8 x 15 w/ 4 stations
- #4: 8 x 15 w/ 4 stations
- #5: 10 x 20 w/ 7 stations
- #6: 10 x 20 w/ 7 stations
- #7: 10 x 20 w/ 7 stations
- #8: 10 x 20 w/ 7 stations



Main Level

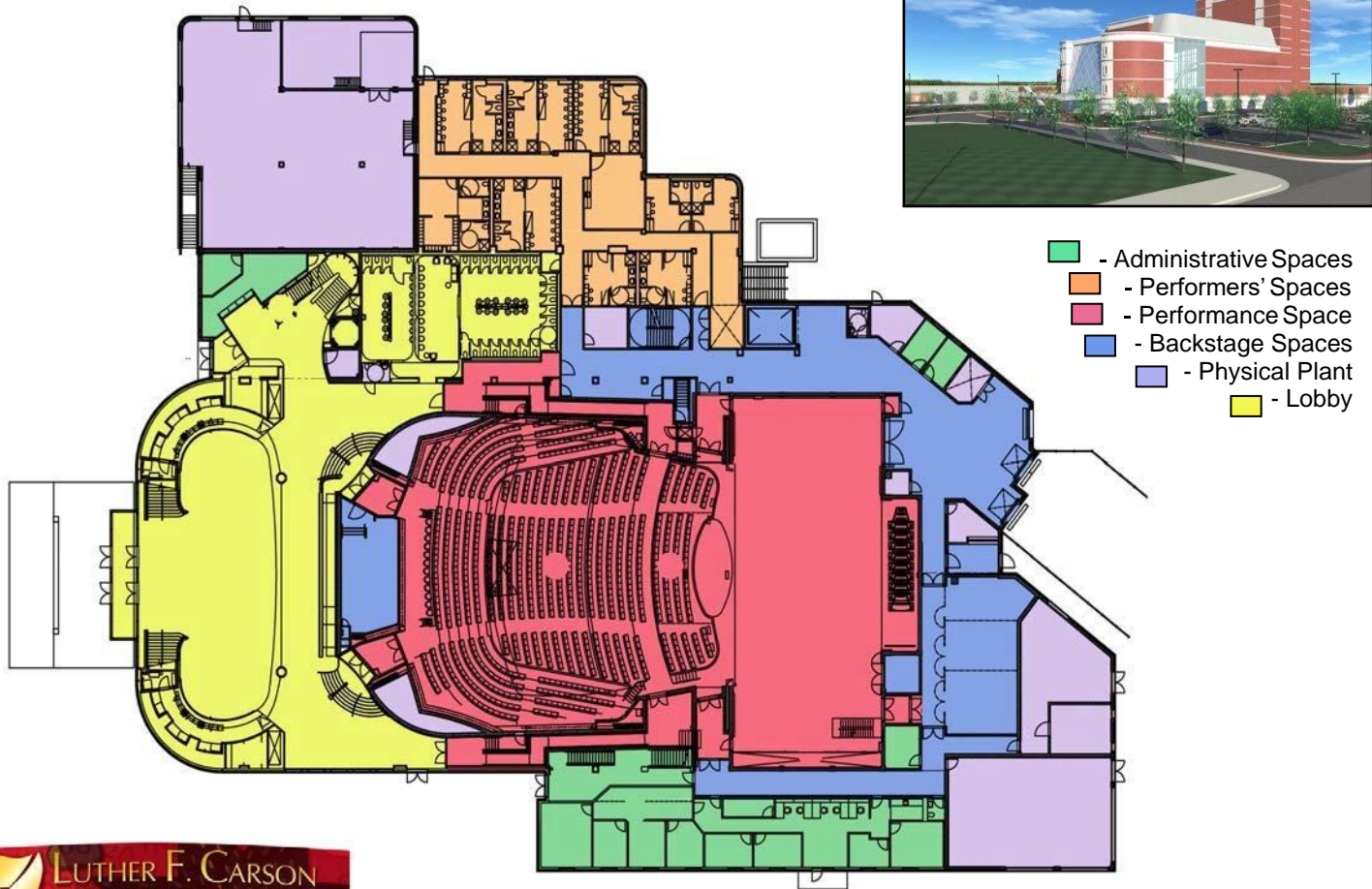

Production Spaces

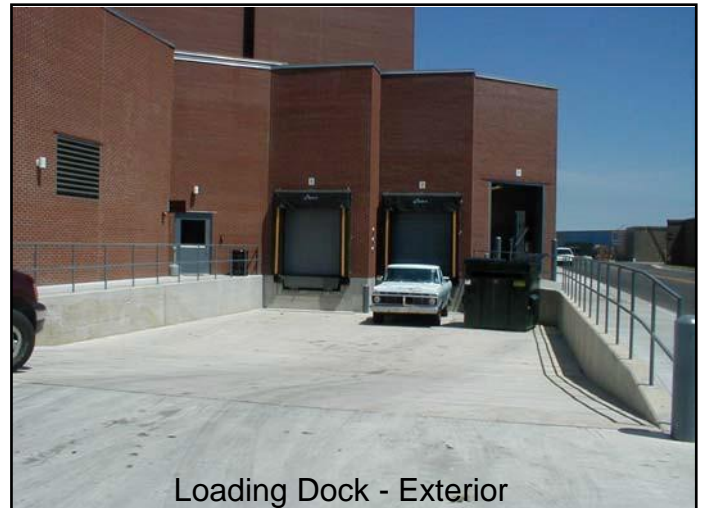

Loading Dock - Exterior



Receiving Room

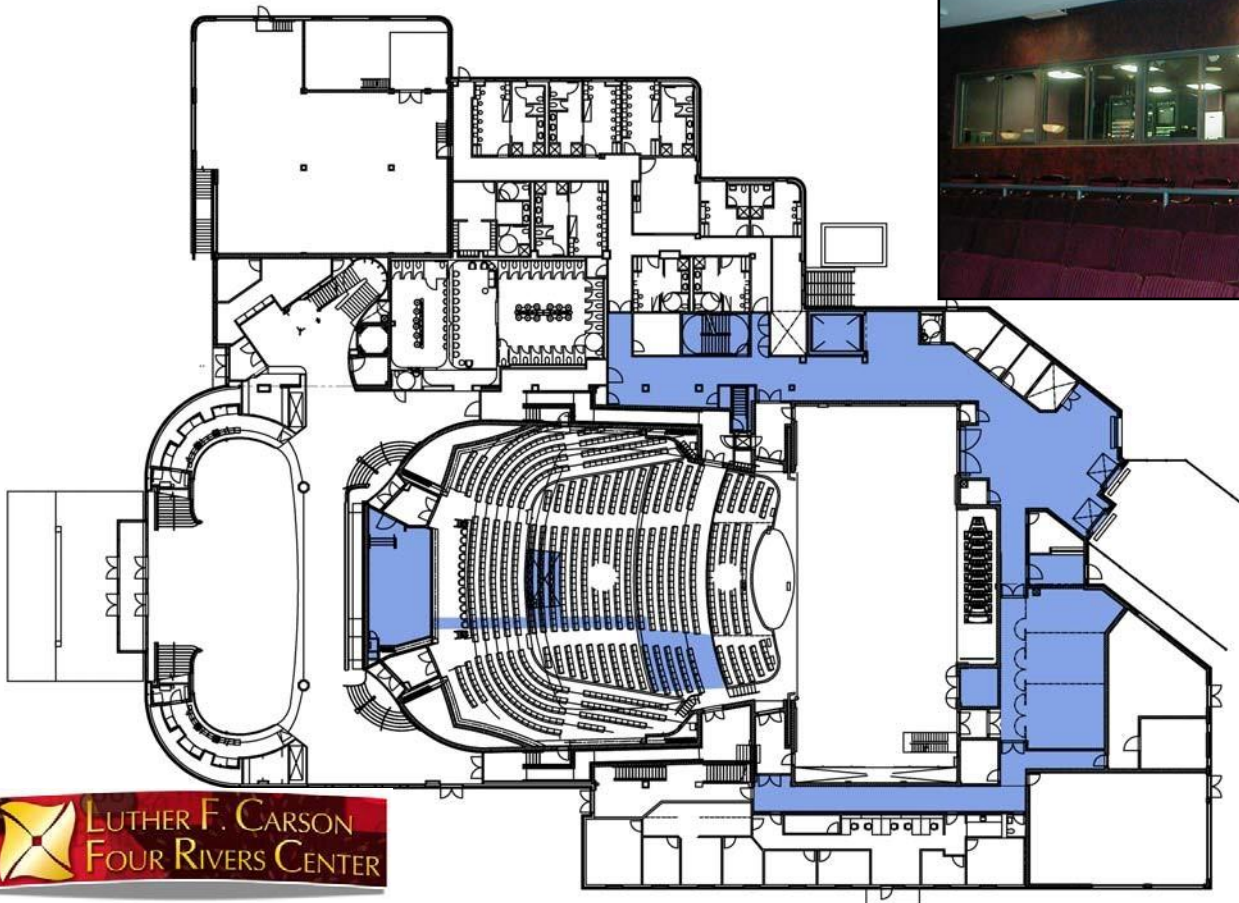

Performers' Spaces



 LUTHER F. CARSON
FOUR RIVERS CENTER

